

SCALE 1:20

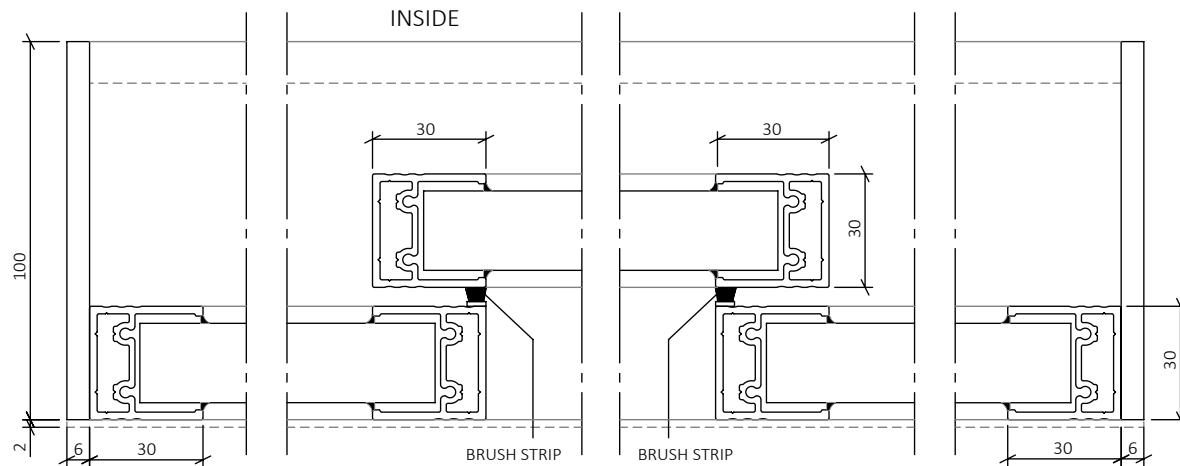

SECTION B-B
SCALE 1:2

OUTSIDE

ErgoSafe[®]
FLEXIBLE GLASS SOLUTIONS

www.ergosafe.se

Category ELECTRICALLY OPERATED SLIDING WINDOW	Date 2023-10-30
Description SLIDEITUP 3-PANEL TRANSOM WINDOW	Scale 1:2 (A4)
Drawn By EI	Drawing number 20070-0012
	Rev -

EXPLANATIONS

ELECTRICALLY OPERATED SLIDING WINDOW, ERGOSAFE SLIDEITUP 3-PANEL TRANSOM WINDOW. OPENS HORIZONTALLY. DESIGNED FOR USE IN CLIMATE BOUNDARIES WITH FRICO 3.1 KW HOT AIR CURTAIN AND STAIN-LESS ELECTRICALLY HEATED BASE PLATE. ALL DIMENSIONS GIVEN IN MILLIMETERS.

WALL OPENING, WIDTH: FOD+ 10 MM
WALL OPENING, HIGHT: FOD+ 5 MM

OPERATION

WINDOW IS EQUIPPED WITH ELECTRIC LOCK AND IMPULSE CONTROL WITH SAFETY BUFFERS. AUTOMATIC LOCK IN CLOSED POSITION. MOTOR AND DRIVE ARE INTEGRATED IN THE WINDOW DESIGN. CONNECTS TO 230 V WALL OUTLET. POWER ADAPTER AND PUSH BUTTON KEYPAD WITH 2 METER CORD INCLUDED.

SURFACE FINISH

NATURAL ANODIZED ALUMINIUM AS STANDARD. CAN BE PAINTED OR ANODIZED IN OTHER COLOURS (RAL/NCs).

GLASS

D4-12 TEMPERED INSULATING GLASS AS STANDARD (SAFETY GLASS). CUSTOMIZED UP TO 24 MM THICKNESS, DEPENDING ON LOCATION AND REQUIREMENTS.

OPTIONS

AVAILABLE IN DIFFERENT DESIGNS AND IN MANUAL VERSION. PLEASE CONTACT ERGOSAFE FOR FURTHER INFORMATION.

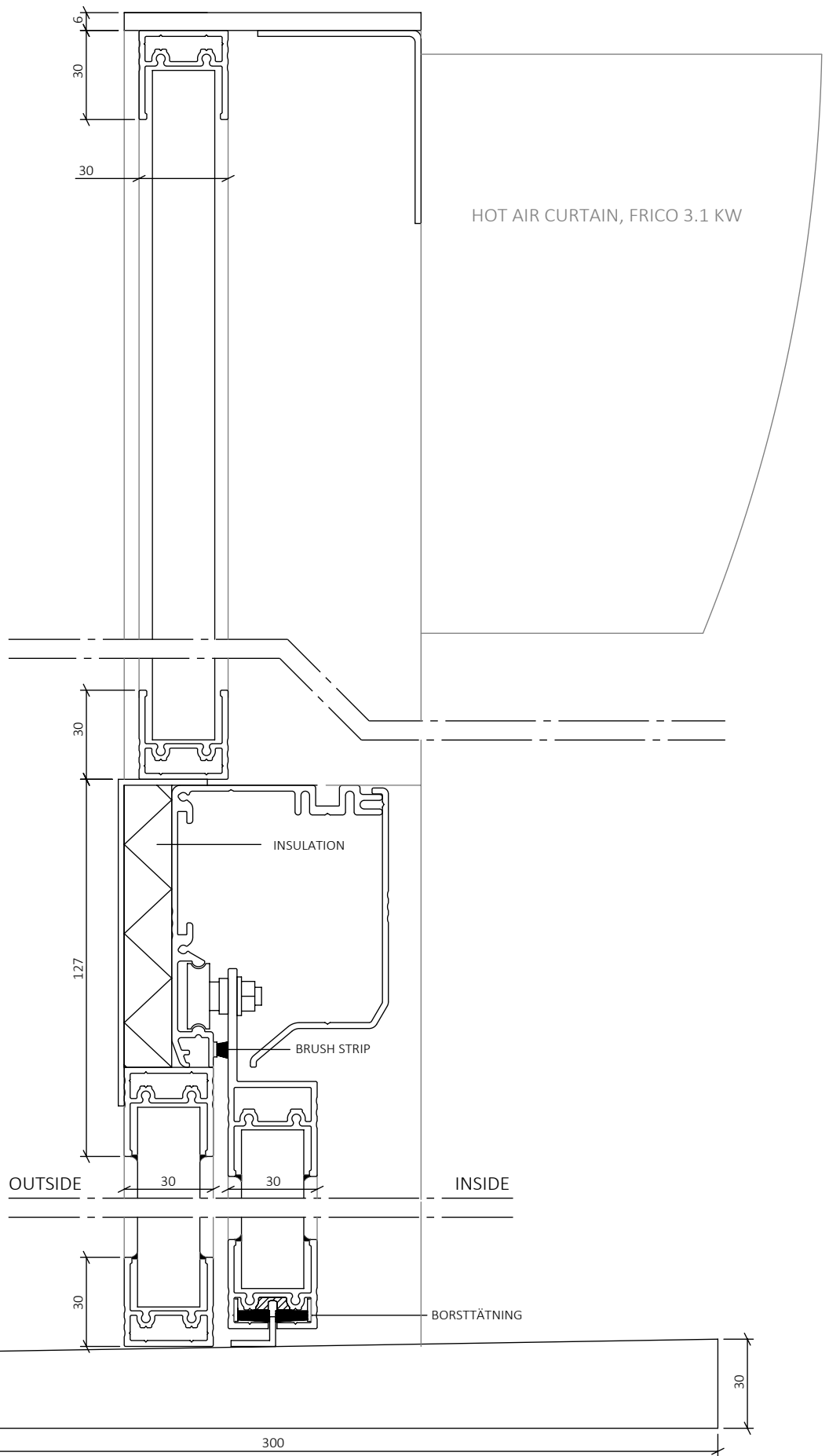

ErgoSafe[®]
 FLEXIBLE GLASS SOLUTIONS

www.ergosafe.se

Category	ELECTRICALLY OPERATED SLIDING WINDOW	Date	2023-10-30
Description	SLIDEITUP 3-PANEL TRANSOM WINDOW	Scale	1:2 (A4)
Drawn By	EI	Drawing number	20070-0012
		Rev	-