

SCALE 1:20

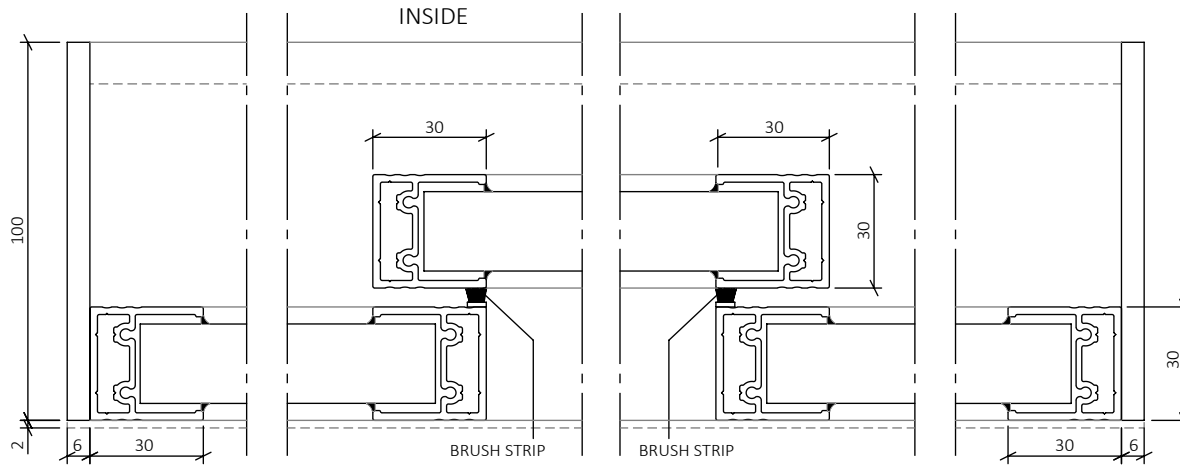

SECTION B-B
SCALE 1:2

OUTSIDE

ErgoSafe[®]
FLEXIBLE GLASS SOLUTIONS

www.ergosafe.se

Category	ELECTRICALLY OPERATED SLIDING WINDOW		Date	2023-10-30
Description	SLIDEITUP 3-PANEL COVER PLATE		Scale	1:2 (A4)
Drawn By	EI	Drawing number	20070-0011	Rev -

EXPLANATIONS

ELECTRICALLY OPERATED SLIDING WINDOW, ERGOSAFE SLIDEITUP 3-PANEL COVER PLATE. WINDOW OPENS HORIZONTALLY. DESIGNED FOR USE IN CLIMATE BOUNDARIES WITH FRICO 3.1 KW HOT AIR CURTAIN AND STAINLESS ELECTRICALLY HEATED BASE PLATE. ALL DIMENSIONS GIVEN IN MILLIMETERS.

WALL OPENING, WIDTH: FOD+ 10 MM
WALL OPENING, HIGHT: FOD+ 5 MM

OPERATION

WINDOW IS EQUIPPED WITH ELECTRIC LOCK AND IMPULSE CONTROL WITH SAFETY BUFFERS. AUTOMATIC LOCK IN CLOSED POSITION. MOTOR AND DRIVE ARE INTEGRATED IN THE WINDOW DESIGN. CONNECTS TO 230 V WALL OUTLET. POWER ADAPTER AND PUSH BUTTON KEYPAD WITH 2 METER CORD INCLUDED.

SURFACE FINISH

NATURAL ANODIZED ALUMINIUM AS STANDARD. CAN BE PAINTED OR ANODIZED IN OTHER COLOURS (RAL/NCS).

GLASS

D4-12 TEMPERED INSULATING GLASS AS STANDARD (SAFETY GLASS). CUSTOMIZED UP TO 24 MM THICKNESS, DEPENDING ON LOCATION AND REQUIREMENTS.

OPTIONS

AVAILABLE IN DIFFERENT DESIGNS AND IN MANUAL VERSION. PLEASE CONTACT ERGOSAFE FOR FURTHER INFORMATION.

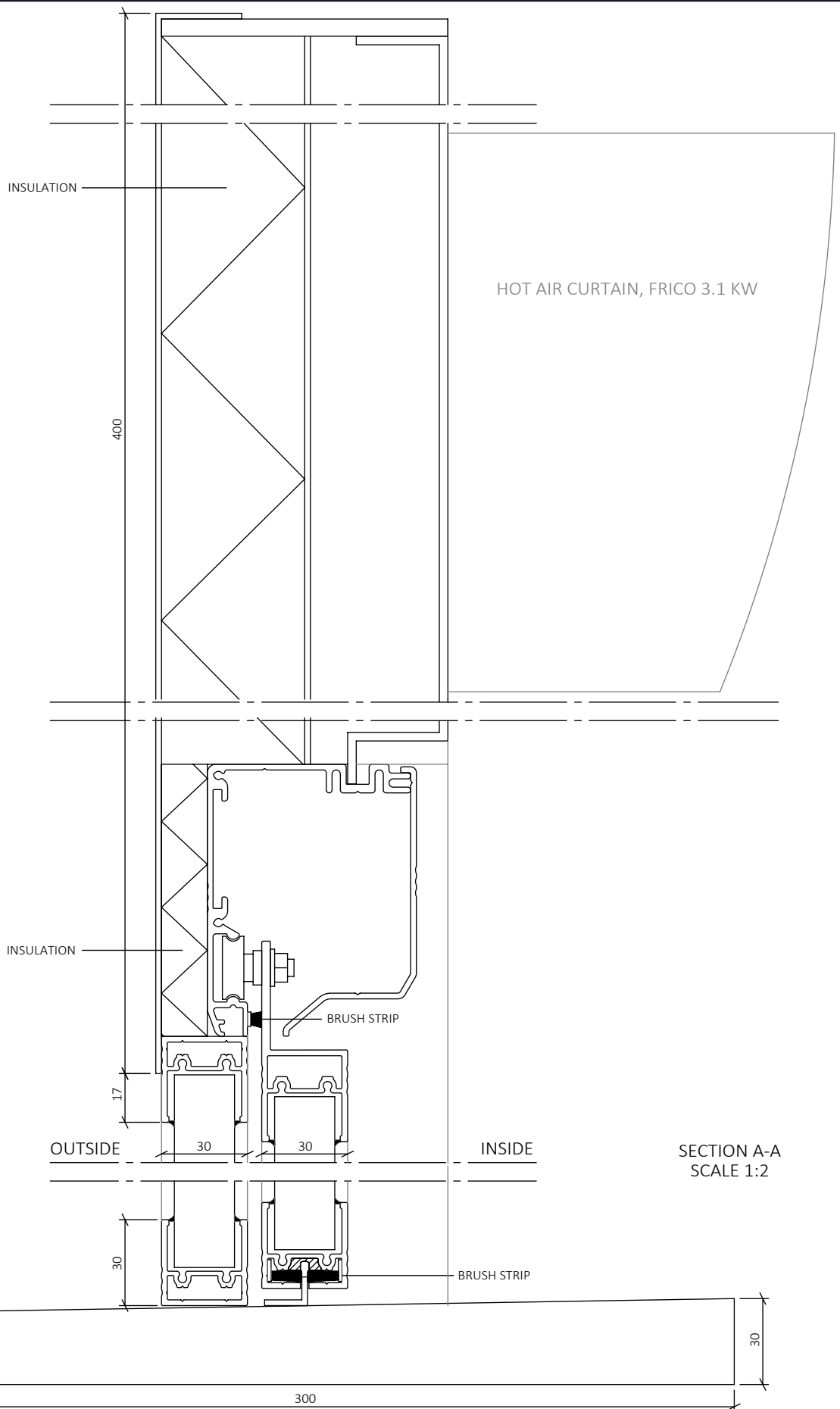

ErgoSafe[®]
FLEXIBLE GLASS SOLUTIONS

www.ergosafe.se

Category
ELECTRICALLY OPERATED SLIDING WINDOW

Description
SLIDEITUP 3-PANEL COVER PLATE

Drawn By
EI

Date
2023-10-30

Scale
1:2 (A4)

Drawing number
20070-0011

Rev
-